

Addendum No. 1

CARGO DOCKS 15 & 16 CONCRETE PAVEMENT

January 11, 2024

1. CHANGES TO BID OPENING DATE AND TIME:

- a. The **Bid Opening Date** has been changed from **Tuesday, January 16, 2024**, to **Friday, January 26, 2024**. The Bid opening time remains at **2:00 P.M.**

2. ISSUES DISCUSSED AT PRE-BID MEETING:

- a. Materials Testing will be at owners expense; contractor will pay for re-tests.
- b. TWIC card is required, or TWIC escort with training and escort ratios (5:1).
- c. No cost for contractor's vehicles to enter the Port of Brownsville.
- d. ID required to enter Dock Areas as well as TWIC card, or TWIC escort.
- e. Asphalt to be removed and hauled off to designated sites selected by the port.
- f. New Fence must be installed before removing existing, unless Port changes.
- g. Pending clarification on paving joints pattern: Port will provide jointing pattern.
- h. Water usage by contractor will be metered but will not be charged.
- i. Limestone base may be reused based on owner and lab recommendations.
- j. Work time is flexible, conditional on availability of inspectors and testing lab.
- k. We will hold a Progress Meeting every two weeks; change as needed.
- l. There will be a 10% retainage on all pay request until project completion.

3. CLARIFICATIONS TO BIDDERS' QUESTIONS:

BIDDER'S QUESTION	OWNER'S RESPONSE
1. Is there specific timing for the work on this project?	Contractor must coordinate closely with BND Staff to always allow access to docks 15 and 16 during construction. The construction sequence plan is included in this Addendum No.1.
2. Can the limestone materials be left out of the contractor's quote?	Limestone materials must be included on the Contractor's bid. BND will decide after inspection if it will not be required.
3. Can the fence on Dock 15 be removed before the new fence is installed?	No. The new fence on Dock 15 Road must be in place before removal of the existing fence. The fence between the docks will be decided later.
4. Will there be doweling to existing concrete?	Yes, Expansion Joint Type D (Sheet 8) will be required when matching to existing concrete throughout the project.

BIDDER'S QUESTION	OWNER'S RESPONSE
5. Will the Port provide a joint plan?	Engineering staff will provide a detailed jointing plan showing what type of joint will be required on each area. Dummy and construction joints will be 10 ft. or less and expansion joints 60 ft. or less.
6. The material from excavation will be disposed by the Port of Brownsville?	All excavation material removed on this project must be hauled by contractor to specific sites in the Port no more than 4 miles from the jobsite.
7. Is reinforced concrete being used for this project?	Yes, reinforced concrete pavement is considered in all sections of this project. A double matt of #6 Rebar Gr 60 @ 12" ctrs., as specified on Sheet 8, must be used.
8. Does the Port know the depth of the existing asphalt pavement? What is the existing asphalt, concrete, flex base cross section thickness?	Construction plans show a 12" Limestone layer, then GeoGrid, then 12" more of Limestone and 3" HMAC. from bottom to top.
9. Will the Port reconsider the 120 calendar days to finish this work?	We will increase the contract time to 150 calendar days, not inclusive of weather delays.
10. Can the contractor work on weekends?	Work during weekends will be allowed (1) if inspectors are available and (2) if the testing lab is available when Lab testing is required.
11. What happens if the lab testing is failed?	Any additional testing due to failed tests will be charged to the contractor. Contractor must comply with the specifications regarding densities and other material requirements.
12. Is there any specific method to remove the existing asphalt material?	The asphalt must be removed by milling so the Port of Brownsville may reuse this material.
13. Is this project Buy America?	No, this project does not need to meet Buy America provisions.
14. Does this project require Davis-Bacon/ Certified Payroll?	No.
15. Can there be a site visit?	Coordination with the BND Engineering Staff is required for site visits. Basic security must be met to access the Port.
16. Will the existing base material whether caliche of limestone be suitable for re-use as the 6" base?	The ideal condition for BND is the use of this material, however, a bid item for limestone is included in case the existing material is unsuitable.
17. Is asphalt milling required for the removal of the existing asphalt?	Yes, asphalt must be removed with milling equipment and hauled to BND designated site.

BIDDER'S QUESTION	OWNER'S RESPONSE
18. Does POB have a place to dispose of the broken concrete?	BND staff will provide a disposal site within Port boundaries, no more than 4 miles from the jobsite.
19. Is there a plan to accommodate Vulcan traffic?	Traffic coordination and construction procedures must be closely monitored. There must be access to Docks 15 and 16 at all times and Vulcan Materials will require an alternative route while contractor works on Phase I.
20. Does the rebar need to be domestic, or can it be imported?	There is no BuyAmerica provision for this project.
21. Will the concrete temperature be controlled? Will the Port be testing all (100%) loads for slump and temperature?	Lab testing specification by BND will be followed. Temperature, slump and strength testing will be required. Frequency will be determined by BND staff.
22. Will a temporary fence be required?	The general area of Docks 15 and 16 is considered a restricted area and requires limited access. All new perimeter fence must be installed before removing the existing fence.
23. Are foreign ID's allowed to access the Port?	<p>In order to enter the Port of Brownsville, we accept any U.S. government-issued identification such as a Visa card or passport, U.S. identification card, or U.S. driver's license. If an individual is operating a motor vehicle, they need to provide a valid U.S. driver's license. If their driver's license is not from the U.S. but is valid, they can provide it along with a U.S. government-issued identification.</p> <p>To enter the Restricted Areas, a valid Transportation Worker Identification Credential (TWIC) is required. If someone does not have a TWIC, they can be escorted in by someone who does hold a TWIC and has completed the TWIC Escort Class. To learn more about available TWIC Escort Classes, please call the Port of Brownsville Police Department at 956-509-2100 and ask for Sergeant Edgar Garcia.</p>
24. Could you provide a detail with the concrete paving cross section where it shows the type of rebar required?	Typical cross section attached to this Addendum No. 1.

BIDDER'S QUESTION	OWNER'S RESPONSE
25. Can the rebar be substituted with Fiber Glass Rebar (typically used in Near Sea / marine environments)?	We will consider alternate materials, but your base bid must be steel reinforcement.
26. Will railroad flaggers be needed during construction due to proximity to the rail lines?	No flaggers are required for this project, the proximity to railroad is minimal on Dock 15 entrance. However, OMNI/Trax – BRG will be notified to join the Pre-Construction meeting for them to be aware of the work being performed in this general area.
27. Will railroad insurance be required in this project?	Railroad insurance is not required.
28. Material Specifications for reinforcement are missing (whether steel or fiberglass rebar if allowed)	Reinforcement shall be steel rebar. However, as stated above, consideration shall be given to an option or alternate bid for fiberglass rebar.
29. Concrete is specified as 3000 psi and does not mention fibersmesh which contradicts plans cross section, which requires 5000 psi with 3lbs of fibersmesh per cy	Concrete shall be 5000 psi with 3 lbs of evenly distributed fibersmesh per CY.
30. Could you specify the Fibermesh for the concrete? Supplier states there are different fibers with different specifications, and different costs.	We are looking for Type II Glass Fiber-Reinforced Concrete conforming to ASTM Specification C1666/C1666M.
31. Could you please provide a list of pre bid attendees?	<p>The Contractors that attended the Mandatory Pre-Bid meeting are:</p> <ul style="list-style-type: none"> • Mor-Will • RDH Site & Concrete LLC • GST Construction • IOC Company • A&I Custom Manufacturing LLC • L&G • Jerdon • Foremost Paving • ZIWA Corp. • Rhyner Construction

Bid Form

CARGO DOCKS 15 & 16 CONCRETE PAVEMENT

Place: Board of Commissioners - Brownsville Navigation District
1000 Foust Road
Brownsville, Texas 78521

Due Date: Before **2:00 P.M., Friday, January 26, 2024.**

Proposal of _____ hereinafter called BIDDER, a corporation organized and existing under the laws of the State of _____, or a partnership or an individual doing business as _____.

To: The Brownsville Navigation District, Texas, hereinafter called OWNER.

Gentlemen:

The BIDDER, in compliance with your invitation for bids for the “**CARGO DOCKS 15 & 16 CONCRETE PAVEMENT**” project, having examined the drawings and specifications with related documents and the site of the proposed work, and being familiar with all of the conditions surrounding the construction of the proposed project, including the availability of materials and labor, hereby proposes to furnish all labor, materials and supplies, and to construct the project in accordance with the contract documents, within the time set forth herein, and at the attached unit prices. These price(s) are to cover all expenses incurred in performing the work required under the contract documents, of which this proposal is a part. These price(s) are firm and shall not be subject to adjustment provided this Proposal is accepted within ninety (90) days after the time set for receipt of proposals.

BIDDER hereby agrees to commence work under this contract on or before a date to be specified in a written “Notice to Proceed” to be issued by the OWNER and to fully complete the project within (150) one hundred and fifty calendar days, as defined in the specifications. BIDDER further agrees to pay as liquidated damages, the sum of five hundred (\$500.00) dollars for each consecutive calendar day thereafter as hereinafter provided in Article 3 of the Agreement.

BIDDER agrees to perform all work for which he contracts as described in the specifications and as shown on the plans, for the attached unit prices:

SUBCONTRACTORS. BIDDER proposes that he will perform the majority of the work at the project site with his own forces and that specific portions of the work not performed by the BIDDER will be subcontracted and performed by the following subcontractors.

Subcontracted Work	Name of Subcontractor
_____	_____
_____	_____
_____	_____
_____	_____
_____	_____
_____	_____

CARGO DOCKS 15 & 16 CONCRETE PAVEMENT

BIDDER Agrees to perform all the work described in the Contract Documents
for the following Unit Prices (which include any and all applicable taxes and fees):

Friday January 26, 2024.

ITEM	DESCRIPTION	EST QTY	UNIT COST	AMOUNT
1	MOBILIZATION AND DEMOBILIZATION	1 LS		
SUBTOTAL MOBILIZATION AND DEMOBILIZATION:				
CARGO DOCK 15 CONCRETE PAVEMENT				
2A	12" EXCAVATION OF EXISTING MATERIALS FOR CONCRETE SLAB	7,971 SY		
3A	6" EXCAVATION OF EXISTING MATERIALS FOR BASE	7,971 SY		
4A	6" LIMESTONE BASE (MATERIAL)	7,971 SY		
5A	INSTALLATION OF 6" LIMESTONE (LABOR)	7,971 SY		
6A	6" SUBGRADE PREP PAVEMENT AREAS (PROOF ROLLING)	7,971 SY		
7A	CONCRETE PAVEMENT (CONT REINF - CRCP) (12")	7,735 SY		
8A	REMOVAL OF EXISTING TRANSITIONAL CONCRETE CURB	1,828 LF		
9A	REMOVAL OF EXISTING FENCE	96 LF		
10A	FURNISH AND INSTALL NEW FENCE	86 LF		
SUBTOTAL FOR DOCK 15 CONCRETE PAVEMENT:				
DOCK 16 CONCRETE PAVEMENT:				
2B	12" EXCAVATION OF EXISTING MATERIALS FOR CONCRETE SLAB	3,082 SY		
3B	6" EXCAVATION OF EXISTING MATERIALS FOR BASE	3,082 SY		
4B	6" LIMESTONE BASE (MATERIAL)	3,082 SY		
5B	INSTALLATION OF 6" LIMESTONE (LABOR)	3,082 SY		
6B	6" SUBGRADE PREP PAVEMENT AREAS (PROOF ROLLING)	3,082 SY		
7B	CONCRETE PAVEMENT (CONT REINF - CRCP) (12")	2,989 SY		
8B	REMOVAL OF EXISTING TRANSITIONAL CONCRETE CURB	702 LF		
9B	REMOVAL OF EXISTING FENCE	188 LF		
10B	FURNISH AND INSTALL NEW FENCE	180 LF		
SUBTOTAL FOR DOCK 16 CONCRETE PAVEMENT:				
TOTAL BASE BID:				

BIDDER Acknowledges receipt of the following addenda:

Addendum 1 (1/11/2024)

In case of discrepancy, the unit price amount shall govern.

The above included prices shall include all labor, materials, excavation, bailing, shoring, removal, backfill, overhead, profit, insurance, etc., to cover the finished work of the several kinds called for.

BIDDER understands that the OWNER reserves the right to reject any or all bids and to waive any informalities in the bidding.

BIDDER agrees that this Bid shall be good and may not be withdrawn for a period of ninety (90) days after the scheduled closing time for receiving bids.

The undersigned hereby declares that only the persons or firms interested in the proposal as principal or principals are named herein, and that no other persons or firms than are herein mentioned have any interest in this Proposal or in the contract to be entered into; that this Proposal is made without connection with any other person, company, or parties likewise submitting a Bid or proposal; and that it is in all respects for and in good faith, without collusion or fraud.

Upon receipt of written notice of the acceptance of this Bid, BIDDER will execute the formal contract attached within ten (10) days and deliver the Performance and Payment Bonds and Insurance Certificates as required under the GENERAL CONDITIONS. The Bid security attached in the sum of _____ (\$ _____) is to become the property of the OWNER in the event the contract, bonds, and insurance certificates are not executed or delivered within the time above set forth, as mutually agreed to liquidated damages and not as a penalty for the delay and additional administrative expense to the OWNER caused thereby; otherwise the Bid security will be returned upon the signing of the contract and delivering the approved bonds and insurance certificates.

Respectfully submitted,

By: _____

Seal affixed here
if BID is by a
Corporation

Title

Address

Attest: _____

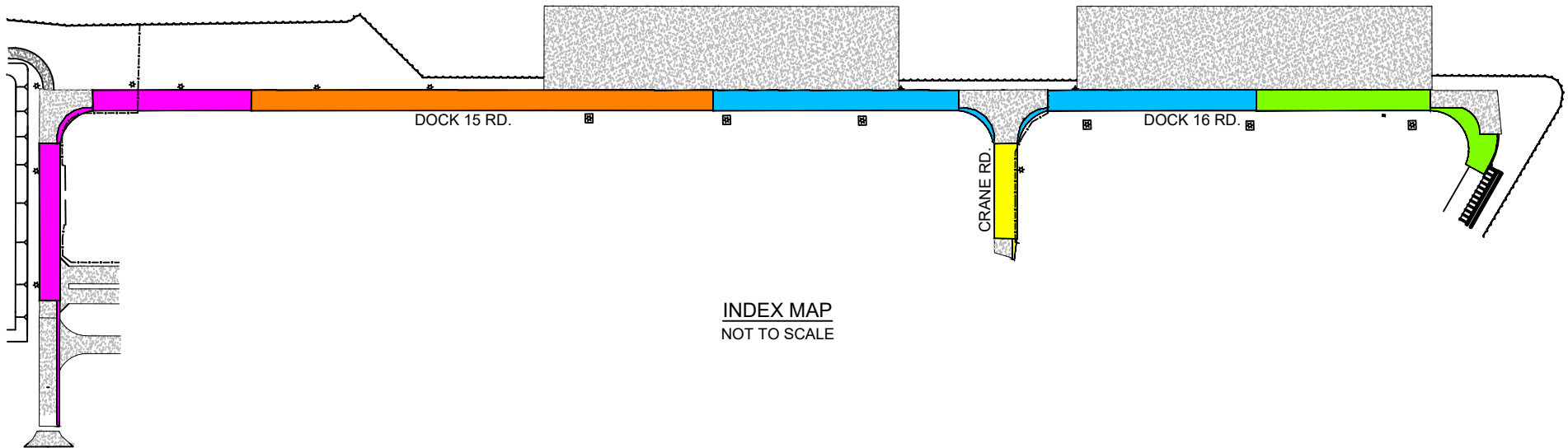

INDEX MAP
NOT TO SCALE

LEGEND

- PHASE I
- PHASE II
- PHASE III - REMOVE FENCE ON CRANE RD.
- PHASE IV
- PHASE V

DRAWN BY :	D. ESTRADA	APPROVED BY :	
DATE DRAWN :	JANUARY, 13 2024	REVISION DATE :	
CHECKED BY :		DWG. NO.	
SCALE :	FILE NAME : Z:\DavidJ\LUIS\15 RD PAVING\Civil\DOCK 15 CONCRETE RECONSTRUCTION LD 11.1.23.dwg		
NTS			

**CARGO DOCKS 15 &16
ROAD CONCRETE PAVING**

**CONSTRUCTION
PHASES**



CONC. PVMT (CONT-REINF JRCP)(12")
 WITH FIBERMESH AT 3 LBS. PER C.Y MIN 5,000 PSI COMPRESSIVE
 STRENGTH AT 28 DAYS. SLUMP 5. TEMPERATURE 95°. ALL EXPOSED CONCRETE SURFACES SHALL BE TREATED WITH CURING
 COMPOUND RESIN IN BASE ASTM 309 WITH PIGMENT TINT OF FUGITICE
 DYE

#6 BARS GR. 60
 @ 12" CTRS.

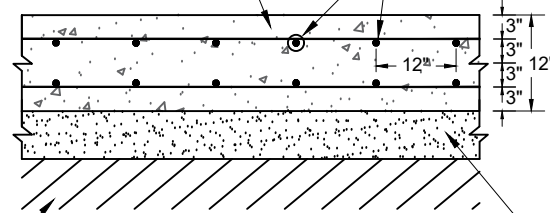

EXST SUBGRADE
 (6") COMPACTED TO AT LEAST
 95% STD. PROCTOR DENSITY

FL BS (COMP IN PLC)
 (TY A GR 1 F)(FNAL POS)
 (6") COMPACTED TO AT LEAST
 98% STD. PROCTOR DENSITY

TYPICAL (12") CONCRETE PAVEMENT DETAIL
 NOT TO SCALE

DRAWN BY :	D. ESTRADA	APPROVED BY :	
DATE DRAWN :	JANUARY, 13 2024	REVISION DATE :	
CHECKED BY :		DWG. NO.	
SCALE :	NTS	FILE NAME :	Z:\David\J\LUIS\15 RD PAVING\Civil\DOCK 15 CONCRETE RECONSTRUCTION LD 11.1.23.dwg

**CARGO DOCKS 15 &16
 ROAD CONCRETE PAVING**

TYPICAL DETAIL

**PORT OF
 BROWNSVILLE**
 the port that works